

## **Big-Metro** For swing gates

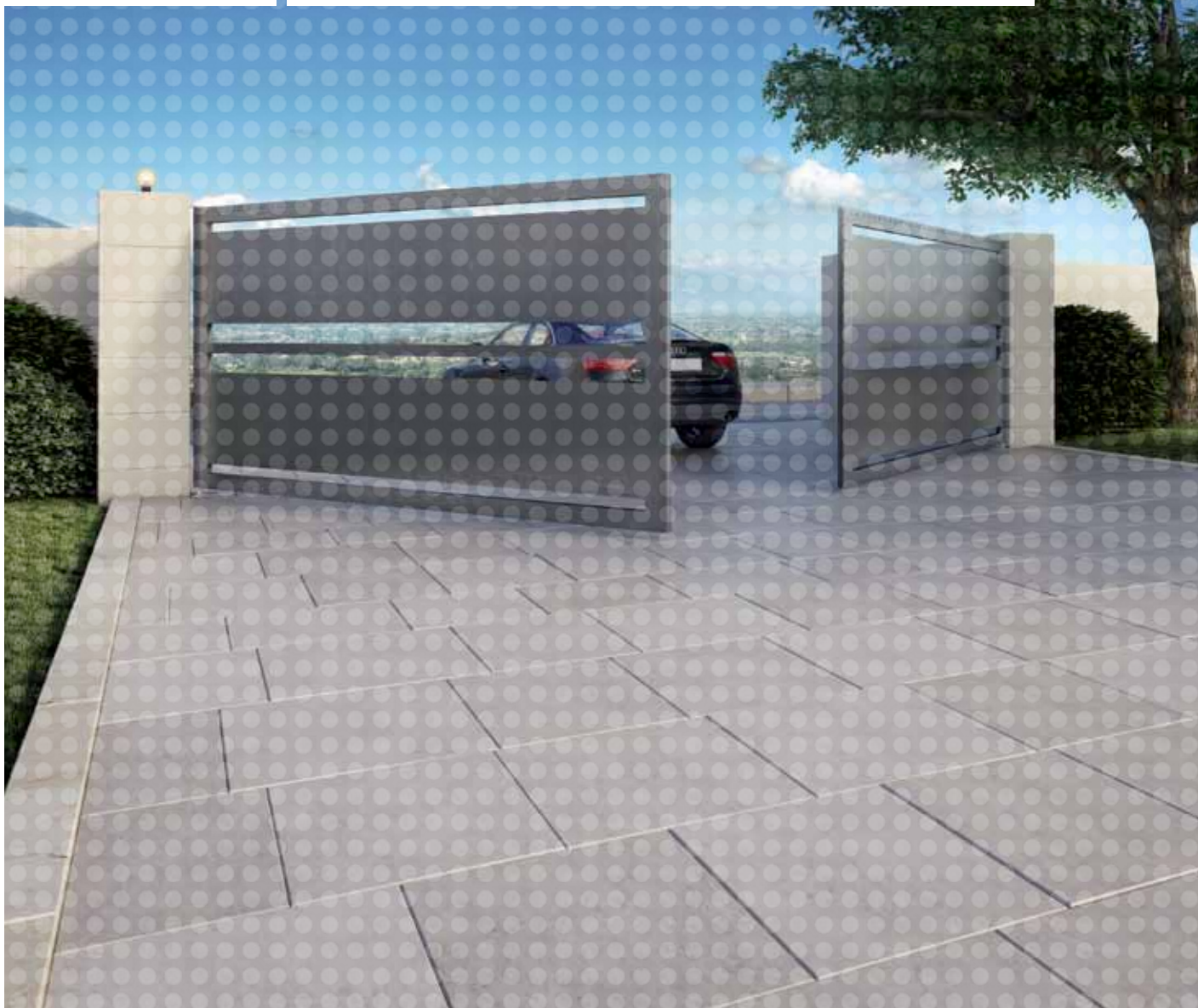

New underground motor for stylish and discreet installation.  
Powerful and rugged, ideal for large gates.

**Nice**

Home Automation



## For swing gates with leaves up to 5 m, underground installation.

Irreversible electromechanical gear motor, also available in 24 Vdc versions with magnetic encoder and mechanical stop.

### Big-Metro Box chamfered foundation boxes with mechanical stop on opening:

- in stainless steel (BMBOXI), ideal for use in extreme conditions,
- with cataphoresis paint finish (BMBOX), highly resistant to corrosion.

**Maximum freedom of choice:** release from inside or outside, two key or lever operated models, freely combinable and easy to operate with just one hand.

**Simple to use:** mechanical stop system on closure. Standard opening to 110°, or optional 360°.

### 24 Vdc version with magnetic encoder.

**Ideal for intensive use,** compatible with the control unit Moonclever MC824H:

- simple programming via a single key;
- self-learning of travel limits on opening and closing;
- self-diagnostics of faults;
- programming of pause time;
- pass door;
- deceleration on opening and closing;
- dual technology obstacle detection;
- operation in the event of a power failure with optional rechargeable batteries (PS324);
- provision for connection of latest generation sensitive edges.

Code	Description	Pack/pallet
<b>BM5024</b>	Irreversible, 24 Vdc, with magnetic encoder, with mechanical stop on closing	18
<b>BMBOX</b>	Foundation box, with cataphoresis paint finish, with built-in mechanical stop on opening	18
<b>BMBOXI</b>	Stainless steel foundation box, with built-in mechanical stop on opening	18

**Note:** key release mechanism, freely compatible with selection of models MEA2 and MEA3 motor.

## Technical specifications

Code	BM5024
<b>Electrical data</b>	
Power supply (Vac 50/60 Hz)	-
Power supply (Vdc)	24
Absorption (A)	7
Power (W)	170
<b>Performance data</b>	
Speed (Rpm)	0.8
Torque (Nm)	400
Work cycle (cycles/hour)	45
<b>Dimensional and general data</b>	
Protection level (IP)	67
Working temp. (°C Min/Max)	-20 ÷ +50
Dimensions (mm)*	400x325x150 h
Weight (kg)	12

\*With foundation box

## Technical layout

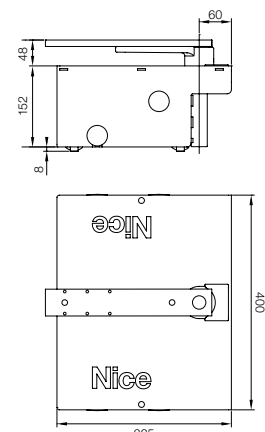

Nice recommends customers order products in pallets in order to facilitate storage and delivery, and ensure packs are uniform. The number of packs per single pallet has been specified for this reason. Approximate draft.

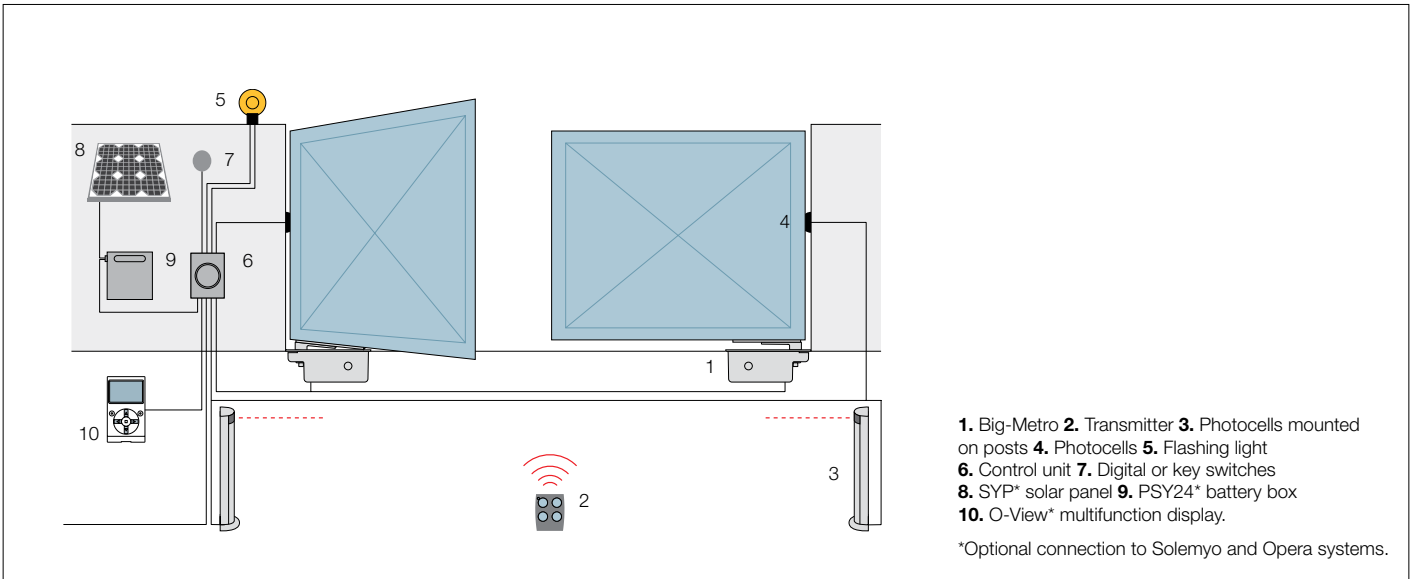

### Accessories

<p><b>MEA2</b> Key unlock system. Pc/pack 1</p>	<p><b>MEA3</b> Lever-type key unlock system to use when system is installed on surfaces such as sand or earth. Pc/pack 1</p>	<p><b>MEA5</b> Lever-type unlock key for MEA3. Pc/pack 4</p>	<p><b>BMA1</b> Accessory for opening up to 360° for gates max. 2.5 m in length. Pc/pack 1</p>	<p><b>PLA10</b> Vertical 12 V electric lock (required for gates longer than 3 m). Pc/pack 1</p>	<p><b>PLA11</b> Horizontal 12 V electric lock (required for gates longer than 3 m). Pc/pack 1</p>
<p><b>TS</b> Signboard. Pc/pack 1</p>	<p><b>PS324</b> 24 V battery with integrated battery charger. Pc/pack 1</p>				

### Utilisation limits

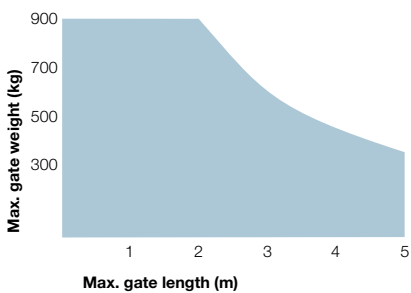

Brand new models of externally foundation box ensuring optimal resistance to corrosion!



## Kit for Opera system



The innovative Opera System enables the installer to manage, program and control automation systems, also remotely, simply and safely, with significant savings in time.



**OVIEW**  
Multifunction display for the control, programming and diagnostics of devices connected via BUS T4.  
Pc/pack 1



**OVBT**  
Bluetooth module for O-View and "O-View Software Suite" for PC, PDA or Smartphone.  
Pc/pack 1



**OVBTGSM**  
GSM module for O-View and "O-View Software Suite" for PC, PDA or Smartphone.  
Pc/pack 1



**OBOX2 - OBOX2B**  
Connection interface complete with software "O-Box Software Suite" with USB connection cable supplied, and integrated Bluetooth module (OBOX2B).  
Pc/pack 1

## Kit for Solemyo solar power system



The solar power kit Solemyo to automate gates, garage doors or road barriers, without the need for costly and invasive excavation work.



**SYKCE**  
Solar power kit comprising SYP photovoltaic panel and PSY24 battery box with charging control circuit.  
Pc/pack 1



**SYP**  
Photovoltaic solar panel for 24 V power supply.  
Pc/pack 1



**PSY24**  
24 V battery box with control circuit and carry handle.  
Pc/pack 1



**SYA1**  
Power supply unit for charging the battery PSY24 from the supply mains.  
Pc/pack 1



**Nice for you**  
Nice constantly researches the most advanced solutions for improving the quality of life by simplifying everyday movements. The key factors to Nice's success are: technological innovation and product design; strong and proven international focus, a capacity for expansion abroad; flexible and efficient business model.



**Click... Nice will take care of it!**  
Nice is the only make that gives you the chance to offer integrated control systems for each type of automation, inside and outside the home.



**Nice Quality**  
Nice has made considerable investments to guarantee increasingly higher quality levels that not only comply with the regulations and directives, but also allow a real continuous improvement of the product.



**Nice Service**  
In order to ensure a complete customer service also in the post-sale phase, Nice guarantees an efficient and timely service.

**Nice**

**Nice SpA**  
Oderzo TV Italia  
Ph. +39.0422.85.38.38  
Fax +39.0422.85.35.85  
info@niceforyou.com

[www.niceforyou.com](http://www.niceforyou.com)

The information shown in this publication is purely indicative. Nice reserves the right to make any modifications to the products as it sees fit.